

CONCRETE SINK WITH OVERFLOW SYSTEM



WHAT YOU WILL NEED



Sink Mold



Overflow Tube



Polycap



Polydome



Beauty Ring



Captive Nut Assembly



Caulking Tool



**Hole
Connector**



Melamine



Paste Mold Release



Molding Clay



Silicone Caulk



**Faucet
Knockouts**



Tape



Brush



Plastic Sheet



Hopper Gun



Face Mix



Backer Mix

Drill holes into the sink mold for the Captive Nut Assembly and the Overflow Hole Connector

1



Create a sink mold out of melamine

2



**Attach the Polydome
to the Polycap,
insert the Captive
Nut Assembly, and
screw it onto your
sink mold.**

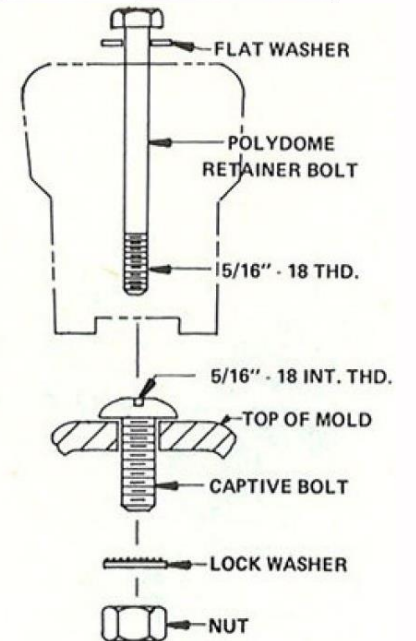
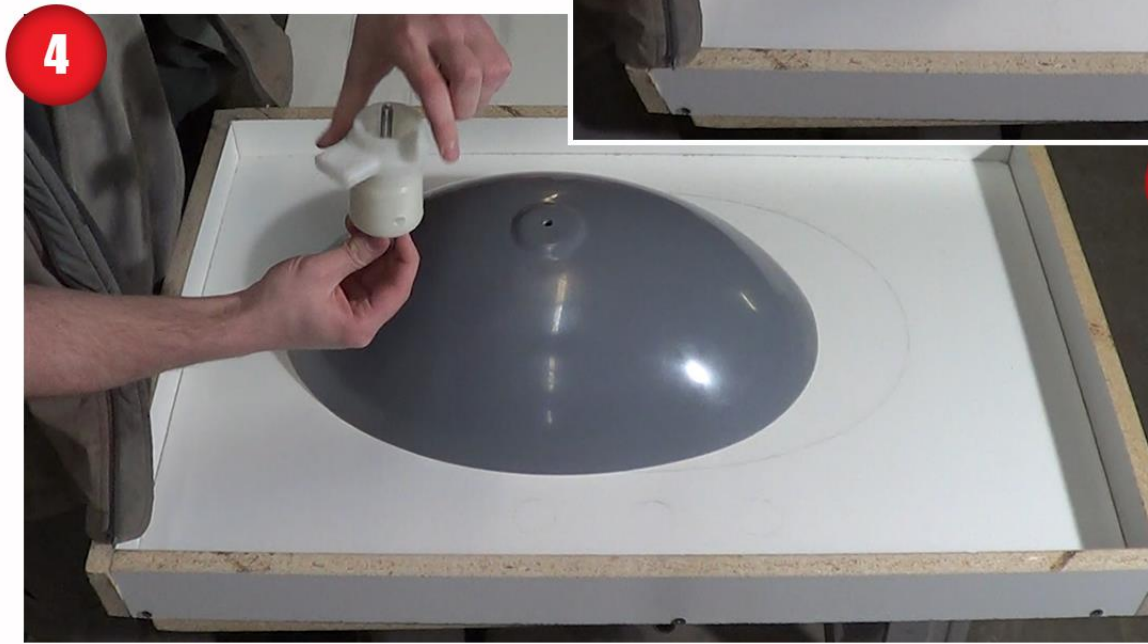

Insert the Overflow Hole Connector



6



Attach the Overflow Tube to the Hole Connector

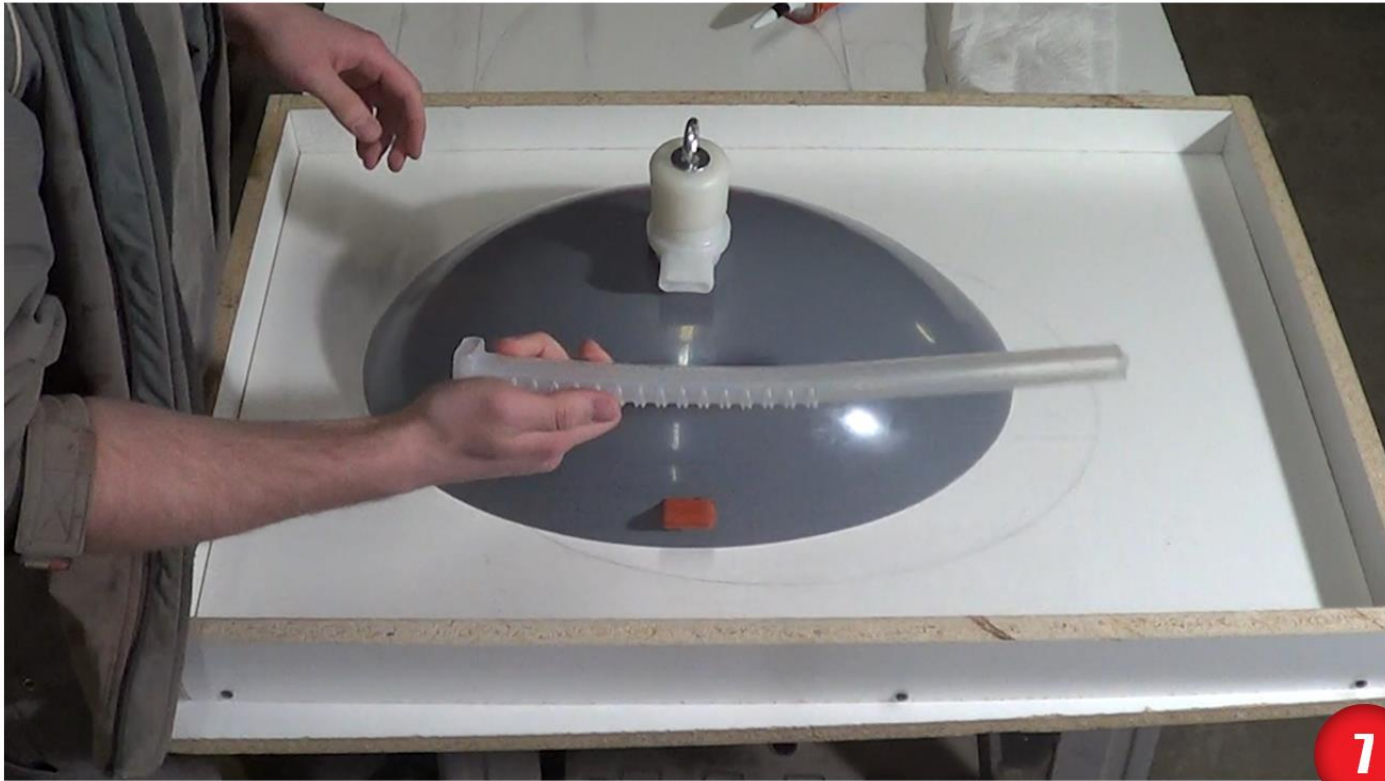

Put molding clay on the bottom of your sink mold to keep it in place while applying silicone

8



9

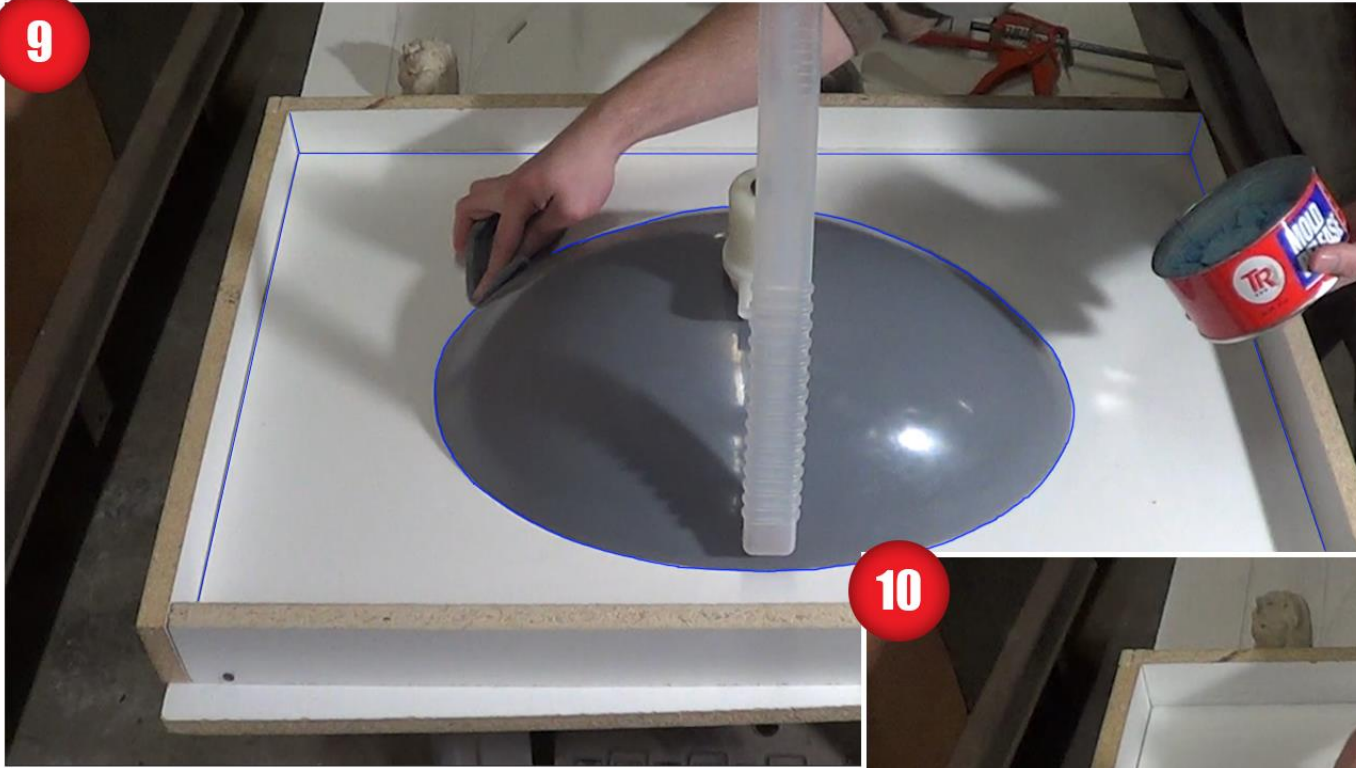

**Apply paste
release to
anything you will
caulk**

10

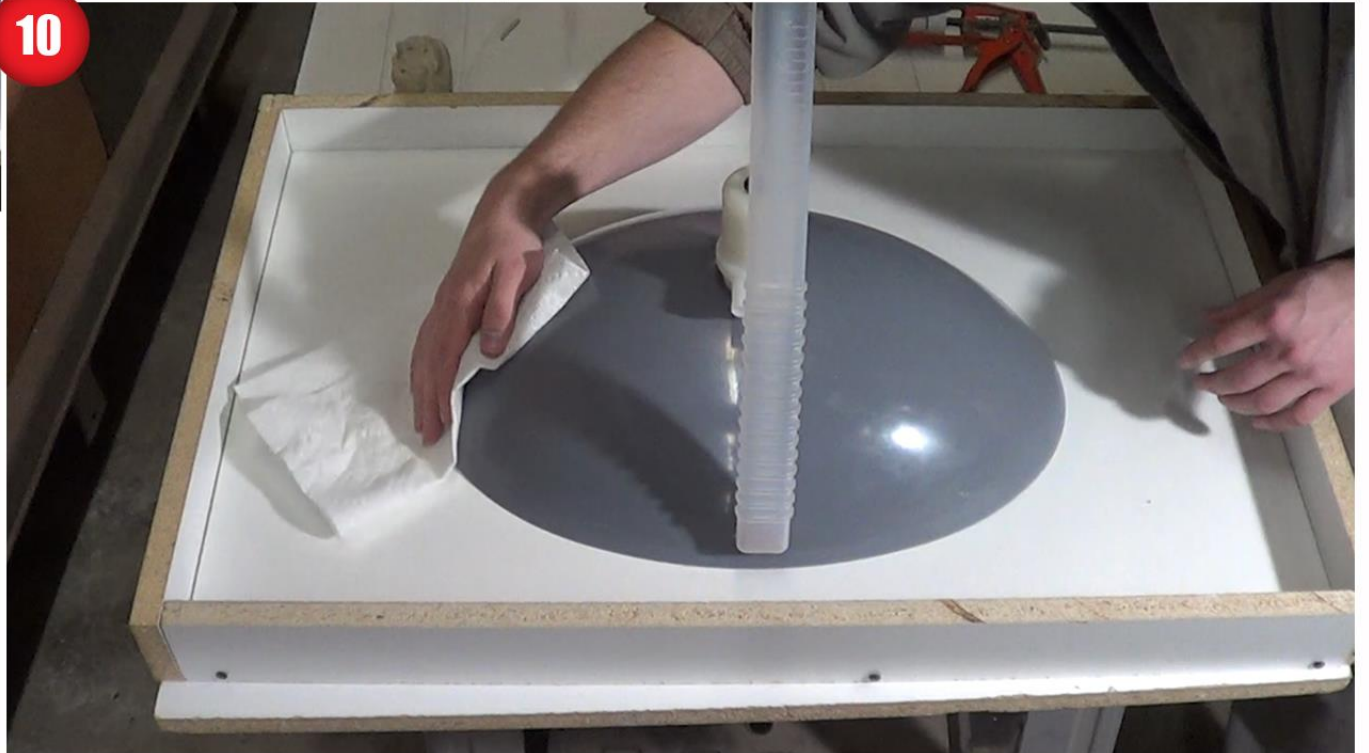

**Remove excess paste
with a paper towel to
remove streaks and
imperfections on your
surface**

**Apply caulk
to any edge
you want to
round off**

11



**Use the
caulking tool
to create a
rounded
edge**



12



13

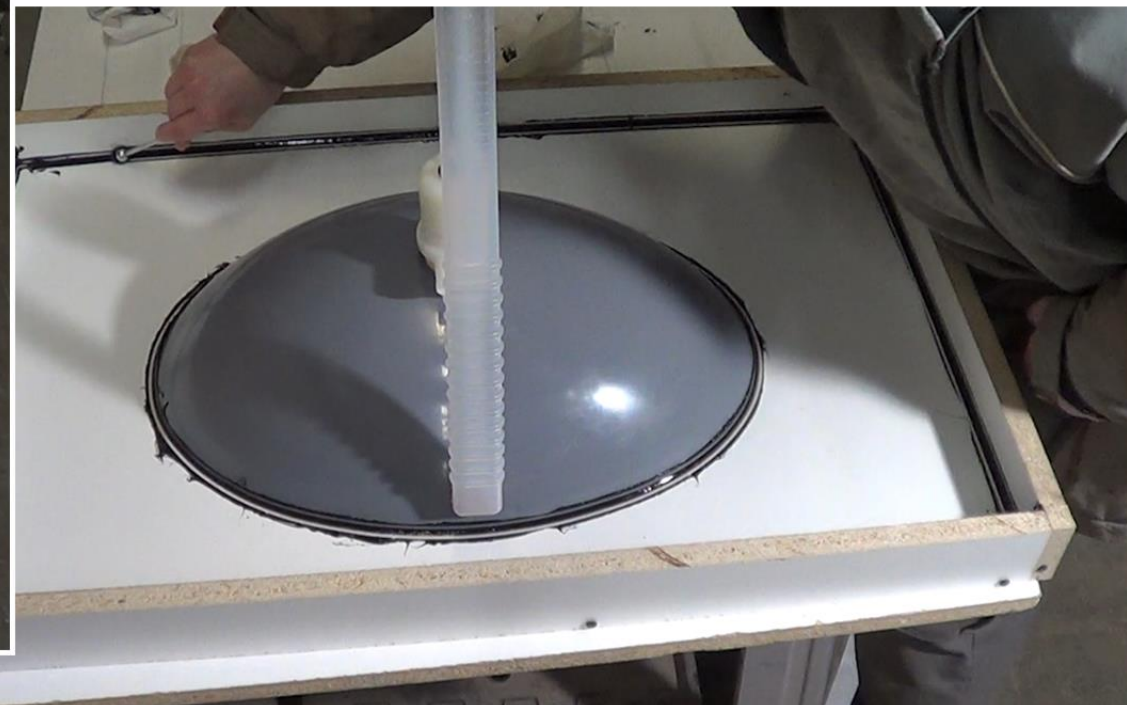
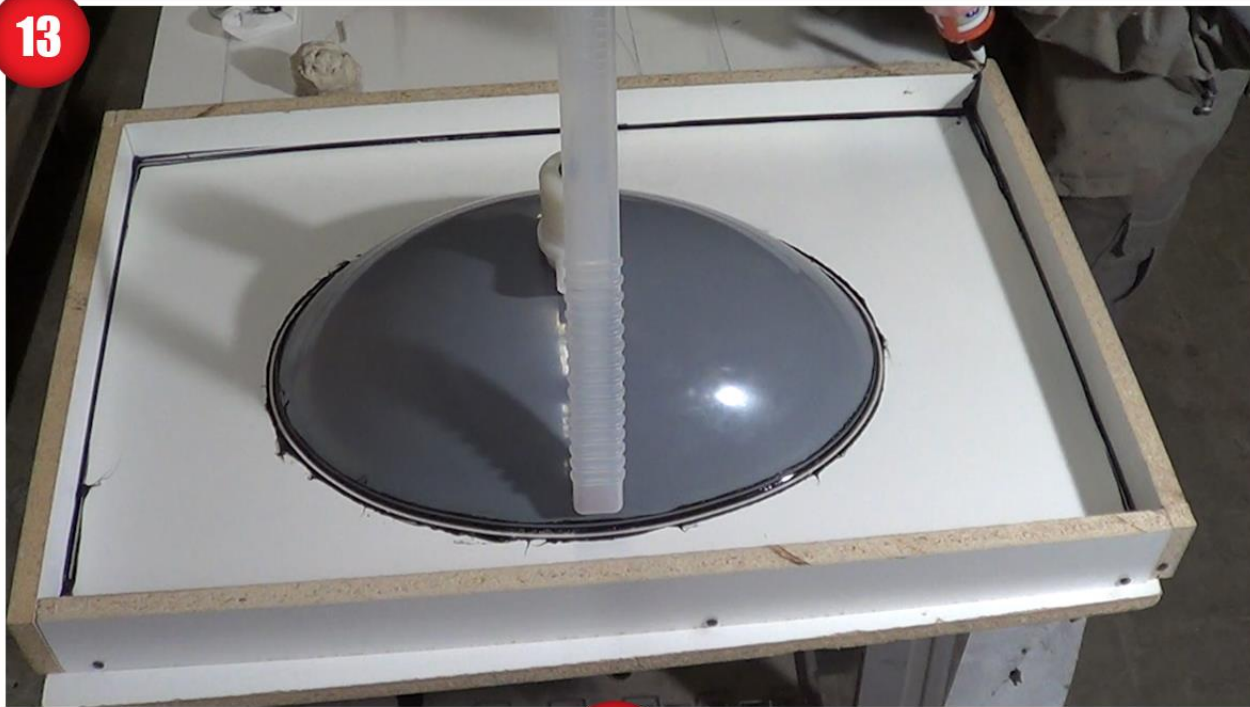

14

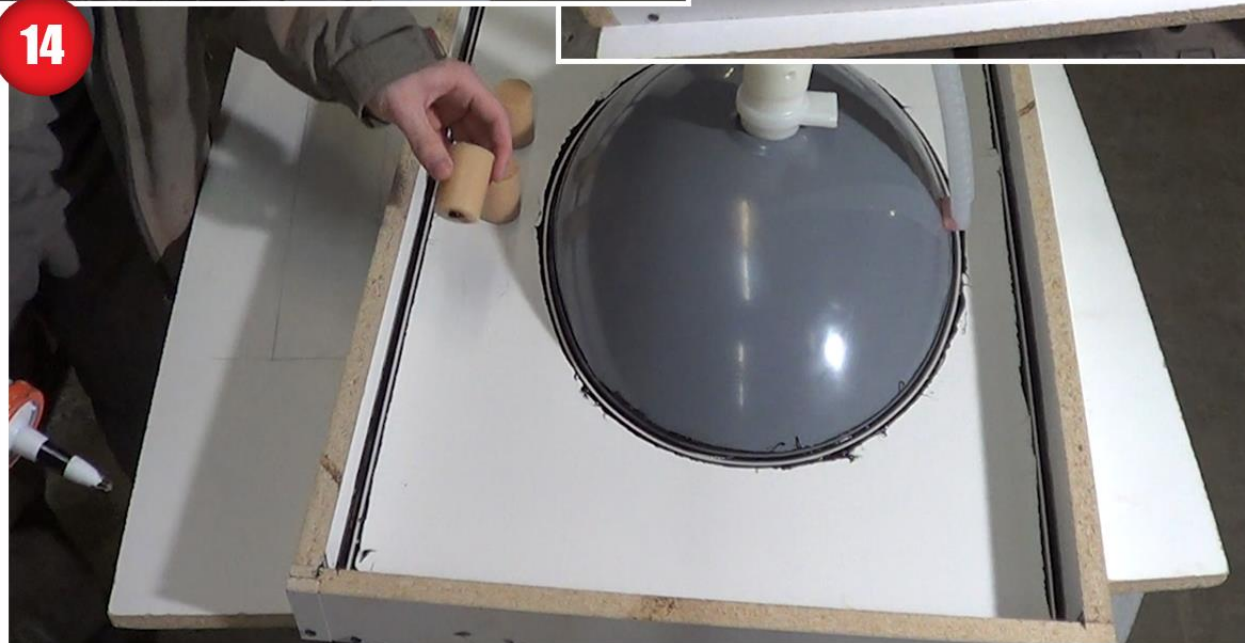

**Attach the
Faucet
Knockouts**

15

**After 24 hours,
remove the
two outer
excess strips**

WARNING
YOU WOULD NOT
BE ABLE TO DO
THIS WITHOUT
THE PASTE
RELEASE

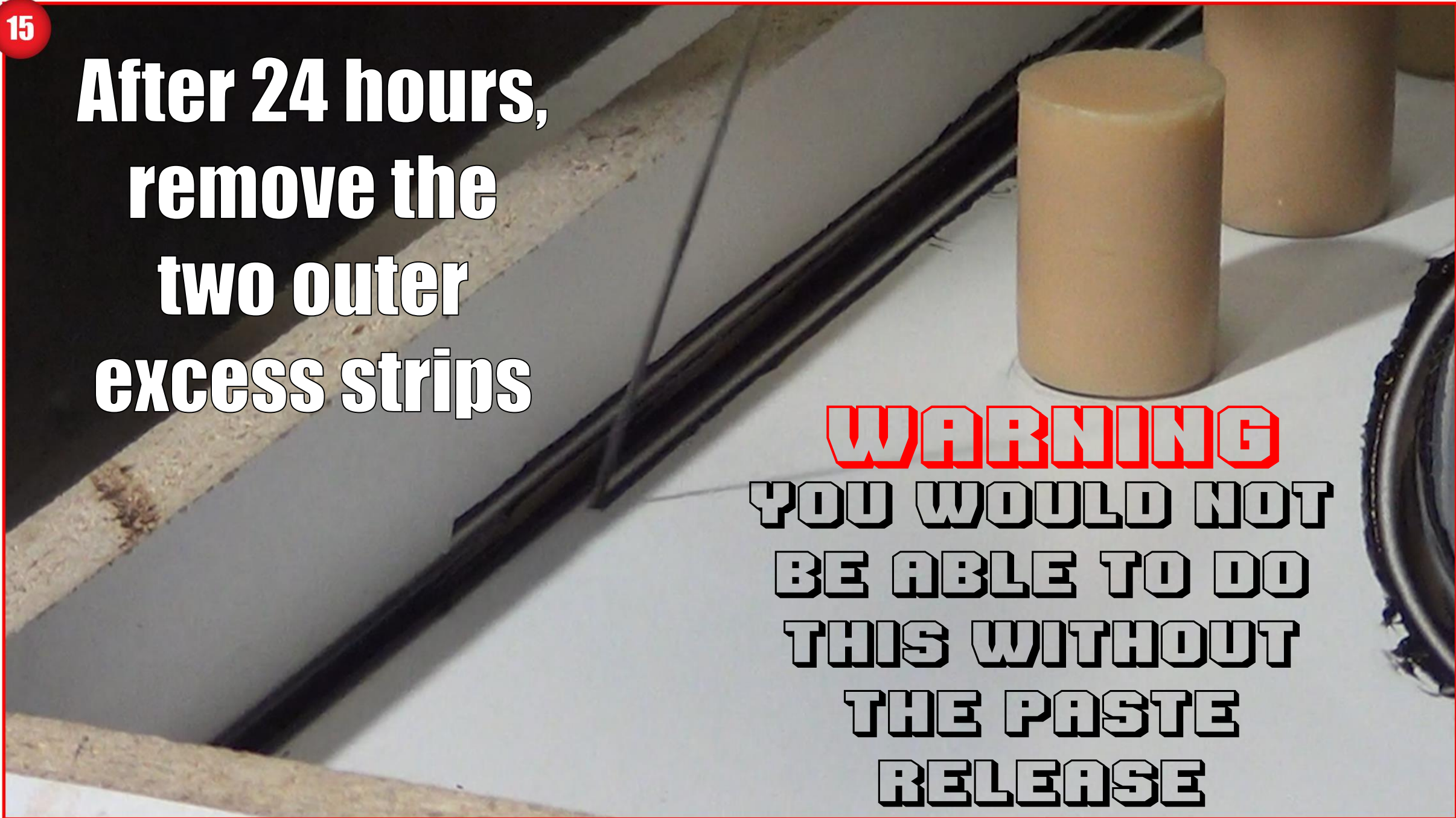

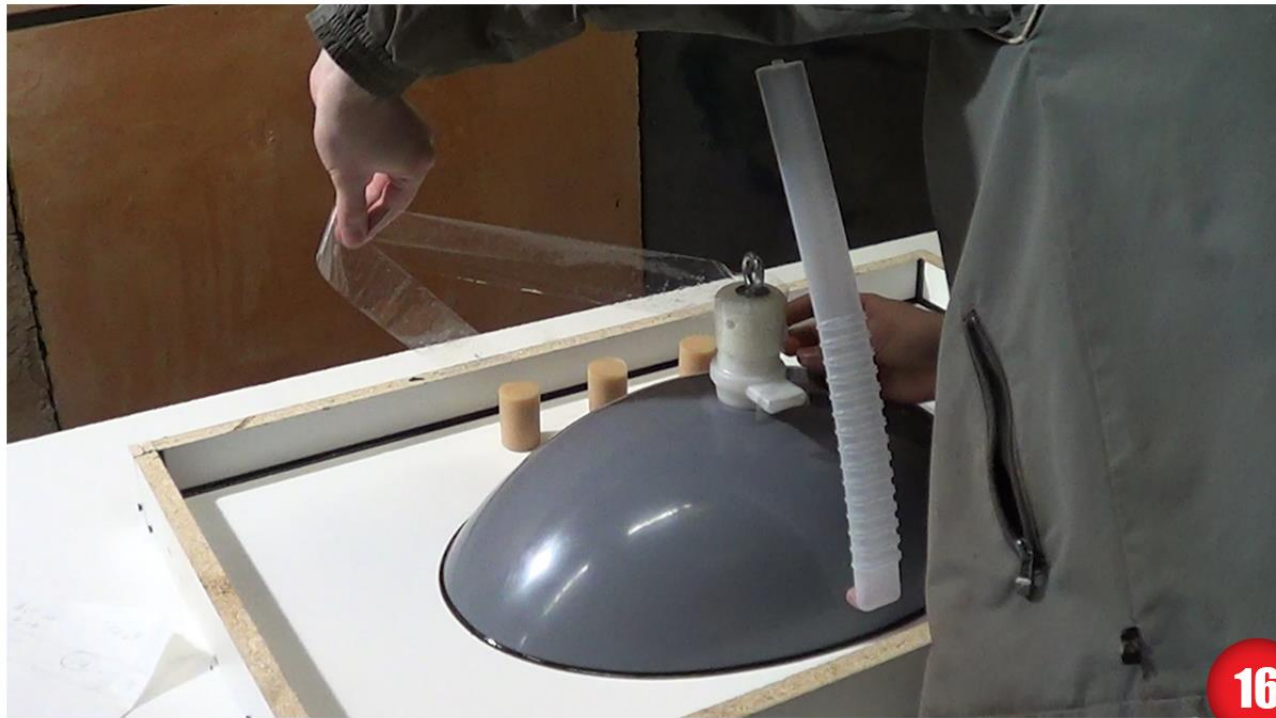

Apply tape to the Polydome, and the hole in the Polycap

16

**THE
POLYDOME IS
REUSABLE!**

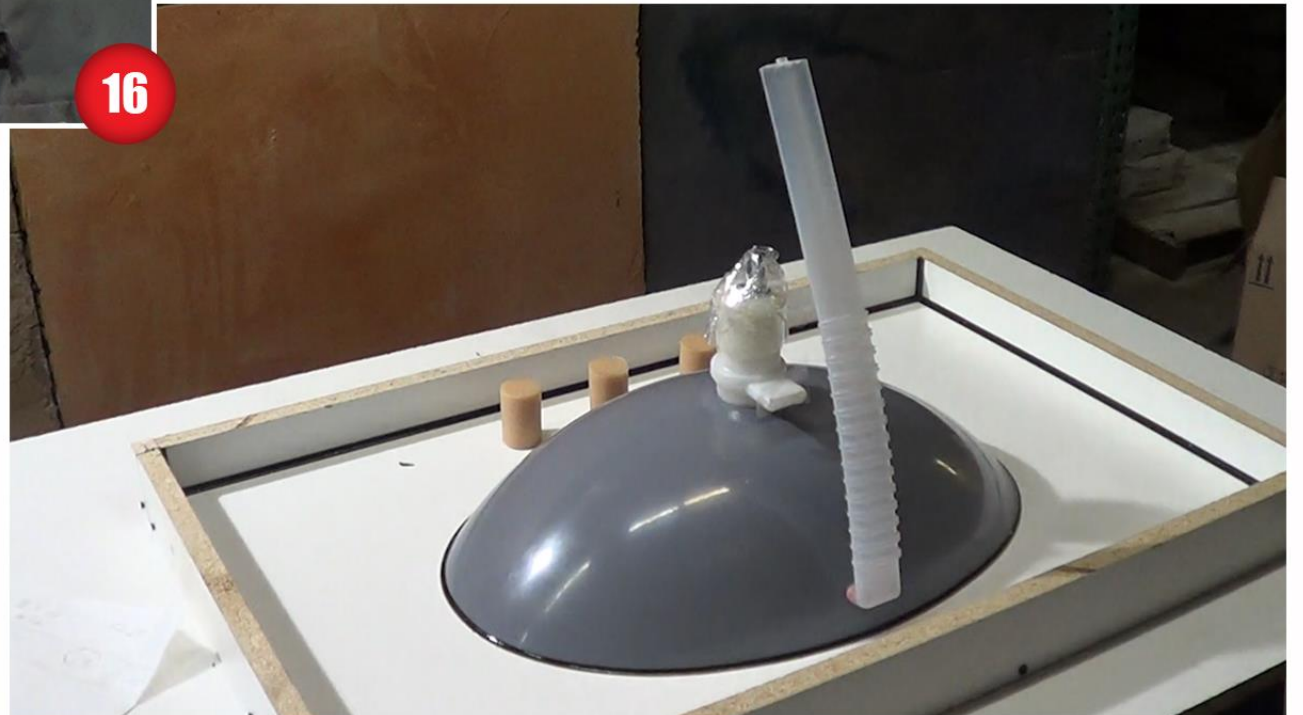

**Shake and pour the
Precast Modifier and
the Face Mix into a
bucket**



**The Precast Modifier increases
the strength, adhesion, retains
moisture, has fast set additives,
and much more! No water
required!**



Mix the Face Mix with an electric mixer in an industrial bucket

18

Scrape the sides of your bucket and mix again





Pour the Face Mix into your hopper gun, set the nozzle size to $\frac{1}{4}$ inch, and the air pressure to 40 PSI

Be sure to test the spray before using the hopper gun on your mold!



19

20

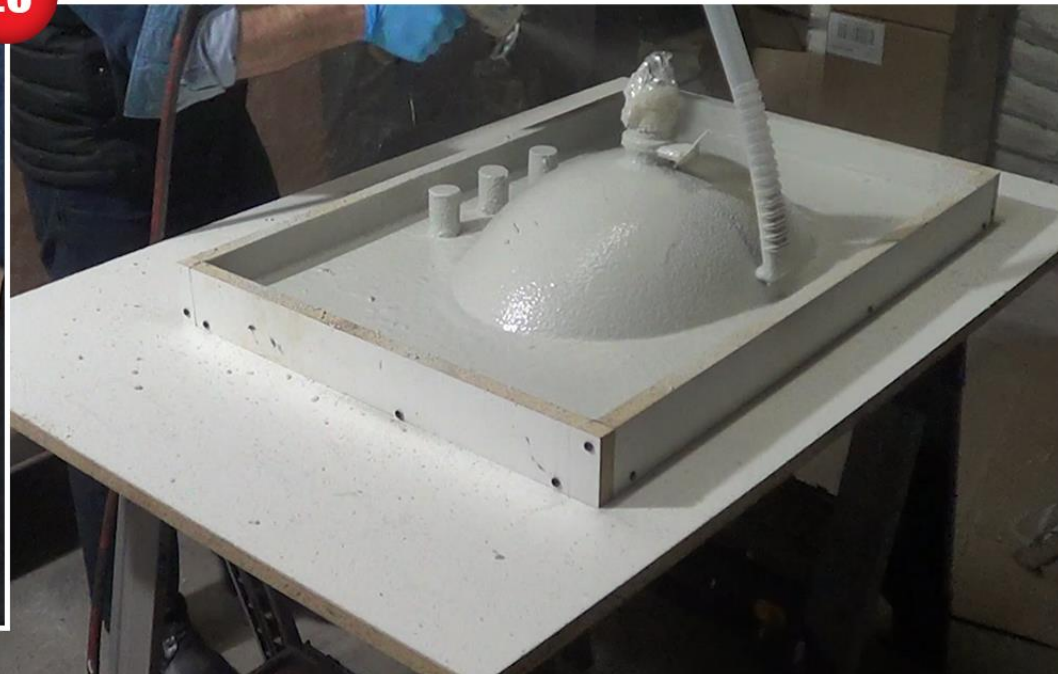
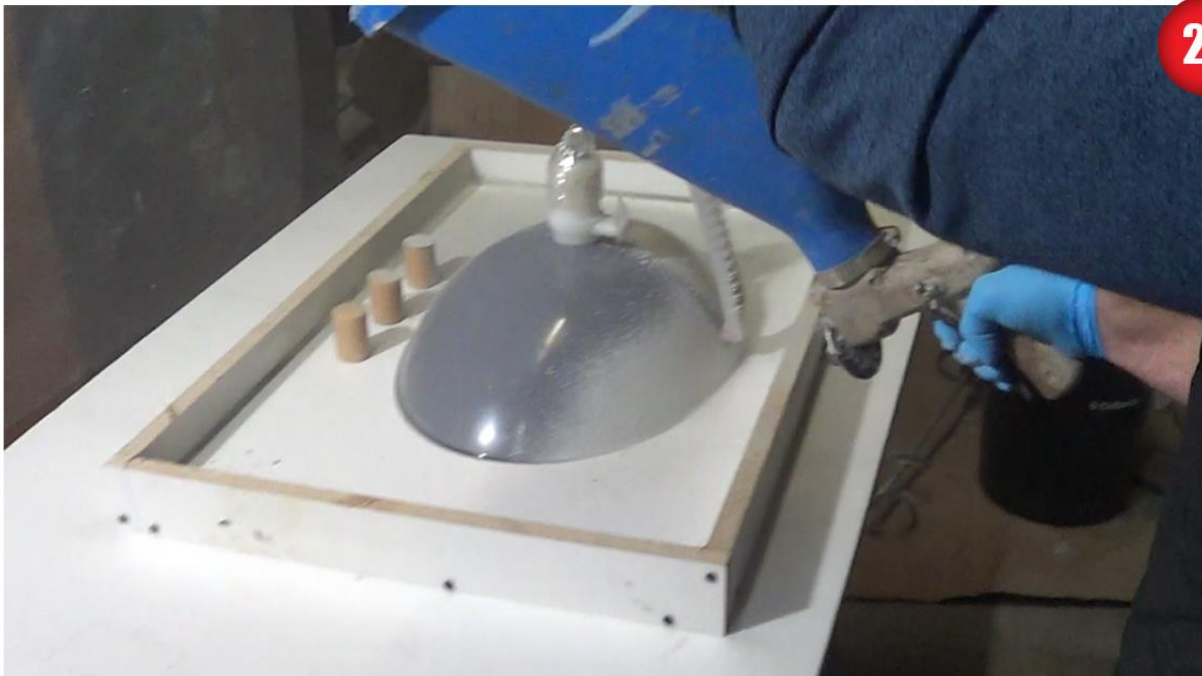

**Spray the Face
Mix on your
entire mold.
Make sure to
cover
everything!**

21



**Fix any
imperfections
by tapping them
with a brush**

22



**Once the face coat
does not stick to your
finger, spray the
second coat**

23



**Waiting too long
will prevent the two
coats from bonding**

24



Cut the Overflow Tube to your desired length, and attach it to your Polycap

25

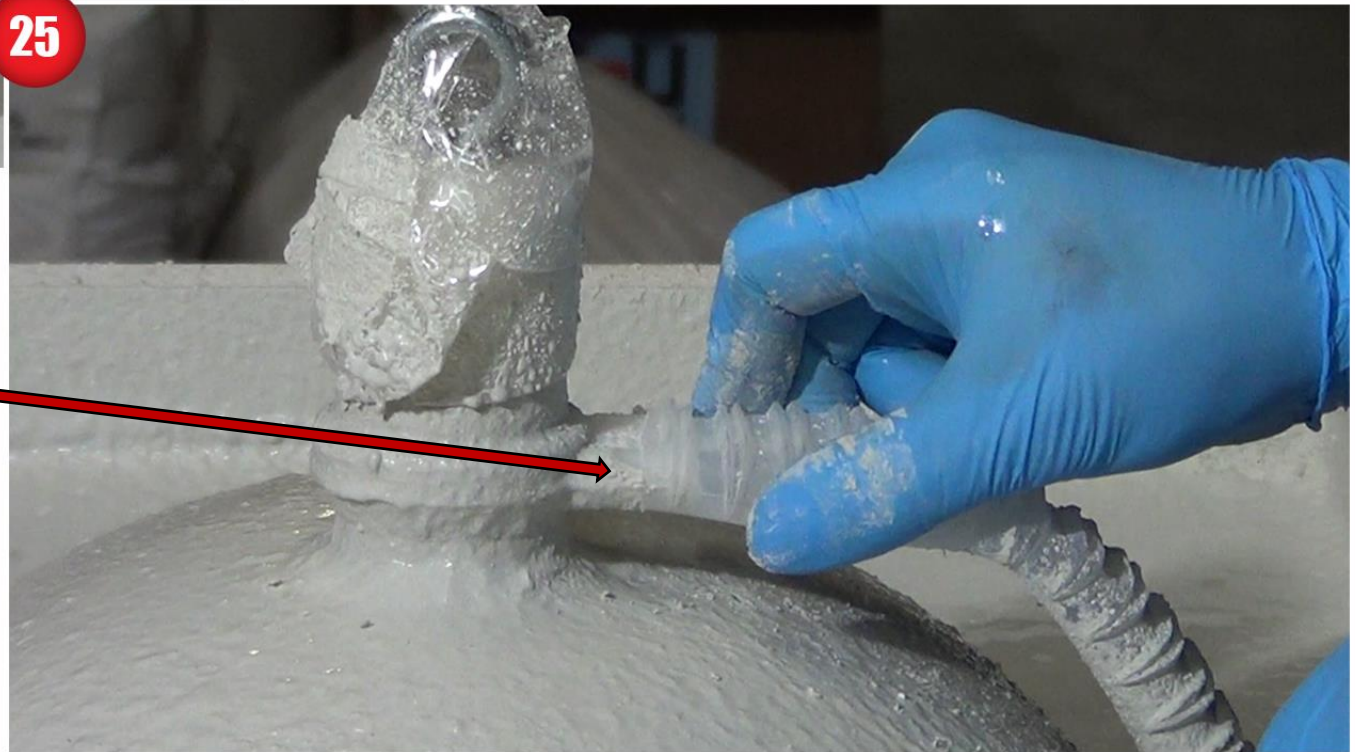

PRO TIP

**CUT SMALL
INCISIONS ON THE
SIDE OF THE TUBE TO
INSERT IT EASIER**

Once the second coat doesn't stick to your finger, mix the Backer Mix



Be sure to shake your precast modifier before pouring it!



**Apply
Backer Mix
at $\frac{3}{4}$ of an
inch**



**Form your drop
edge , and
cover the mold
with plastic
overnight**



32

**Demold,
remove the
Faucet
Knockouts and
the hole
connector, and
insert your
beauty ring.**



To find out how to use our concrete cleaner and our sealer, [click here](#)

